

SUPERINTENDENT OF ELECTIONS

***501 River Street
Paterson, NJ 07524
(973) 881-4515***

QUICK GUIDE FOR END OF NIGHT CLOSING

**DO NOT UNPLUG VOTING MACHINE UNTIL ALL STEPS
BELOW HAVE BEEN COMPLETED!!!**

1. Click on the 3 dashes on the upper right corner, and click **Log Out**

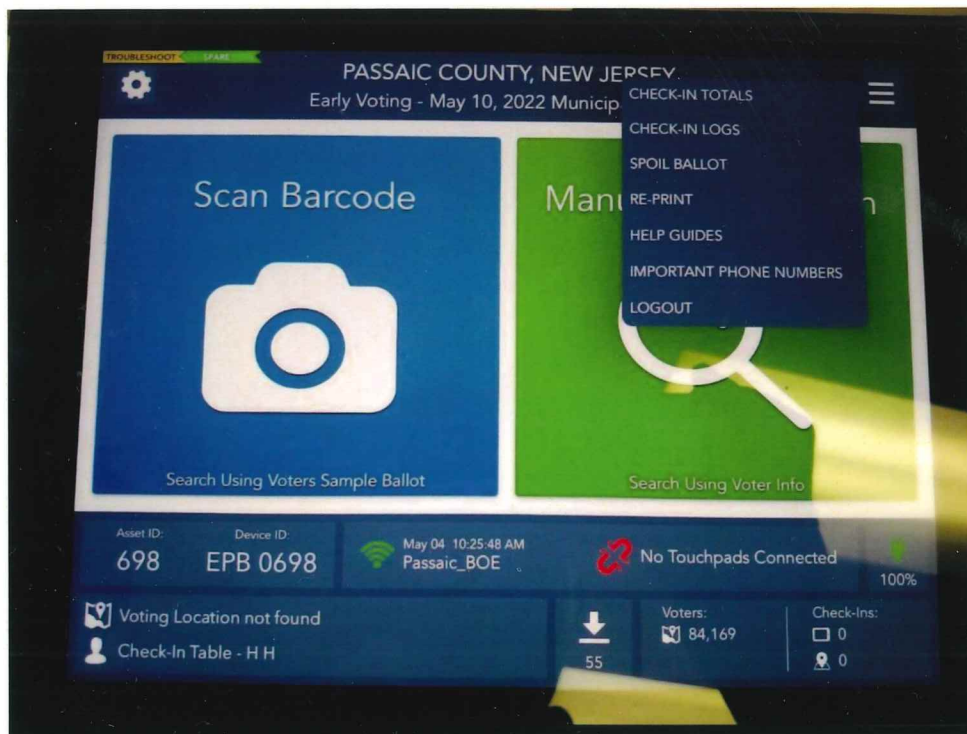

2. Click Close for the day

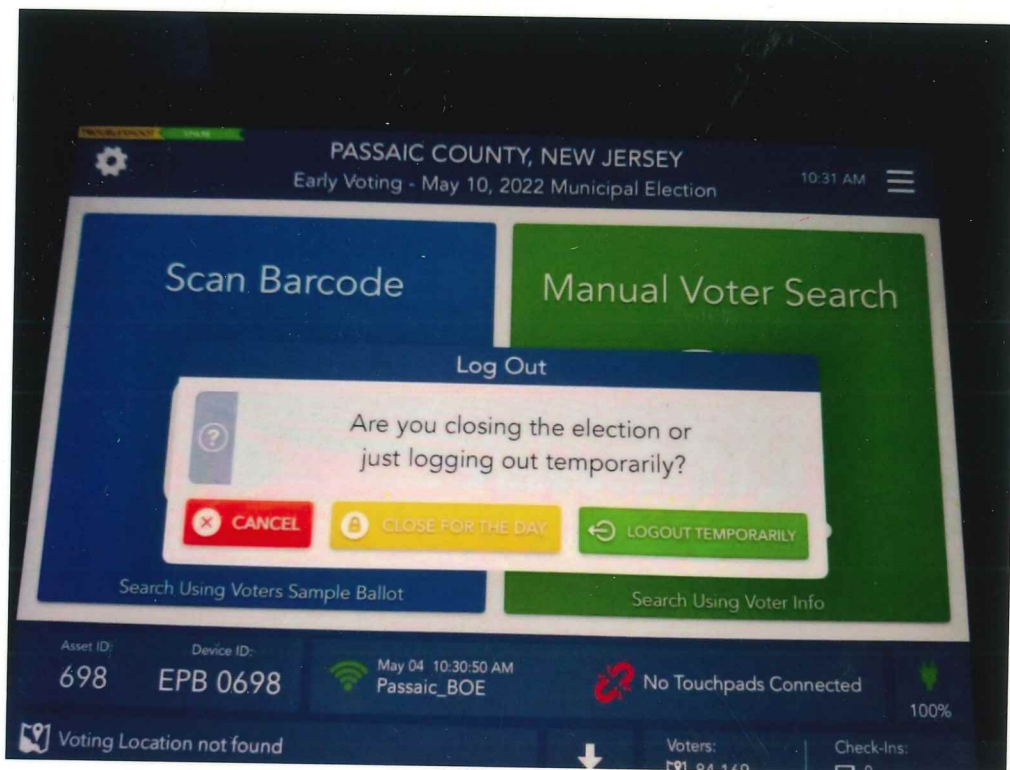

3. Click Yes

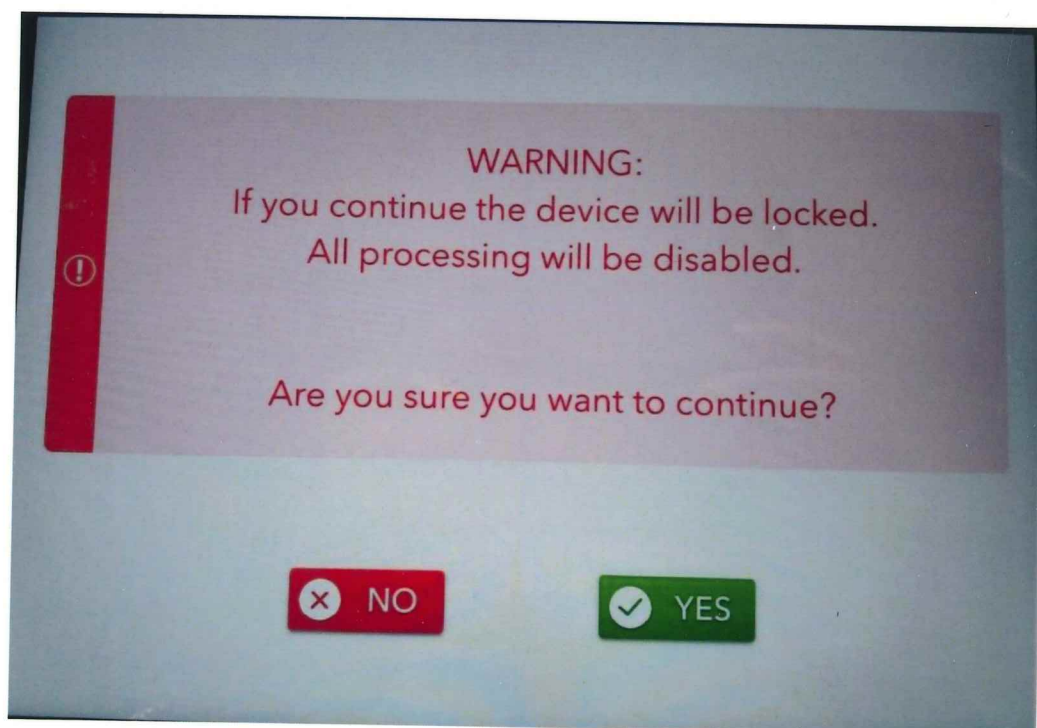

4. Enter the password that was provided to you which is located on the back of the key envelope. Then click the green lock device button

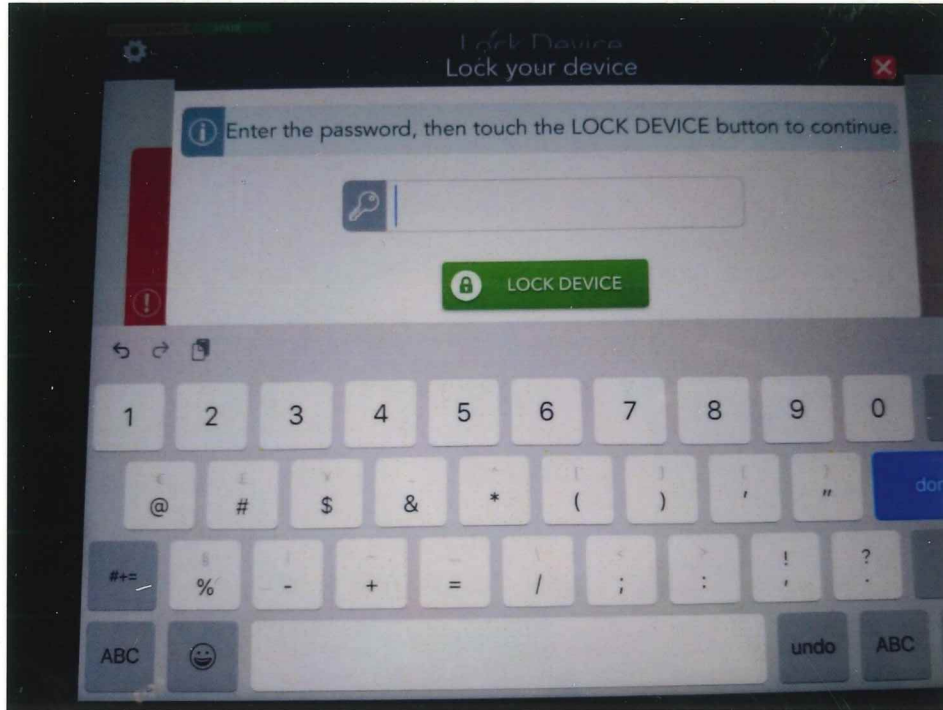

5. Wait for synchronizing to complete

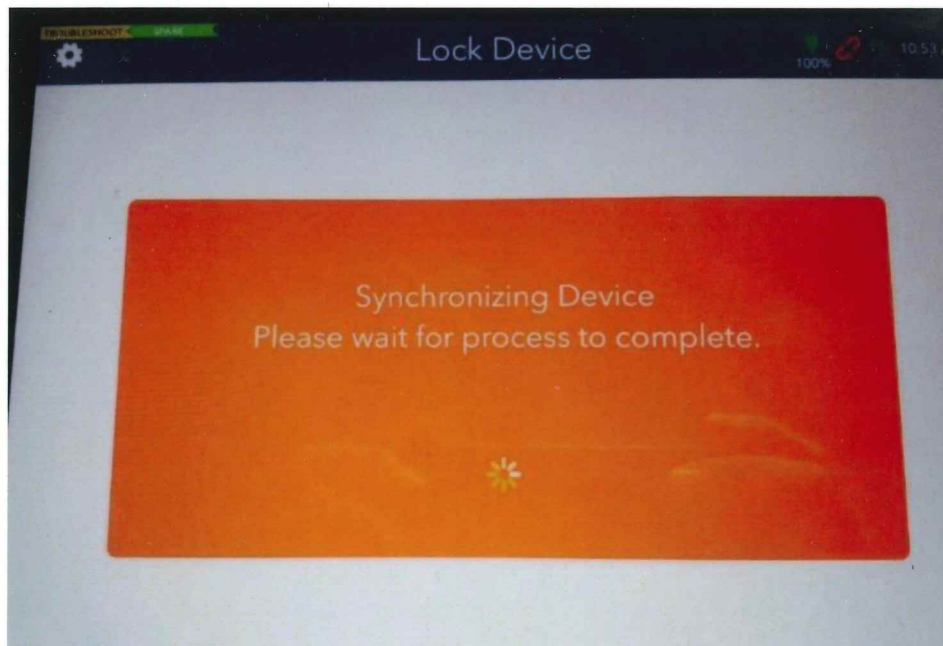

6. If device Locked appears, Click Ok and turn off the E- Poll Book

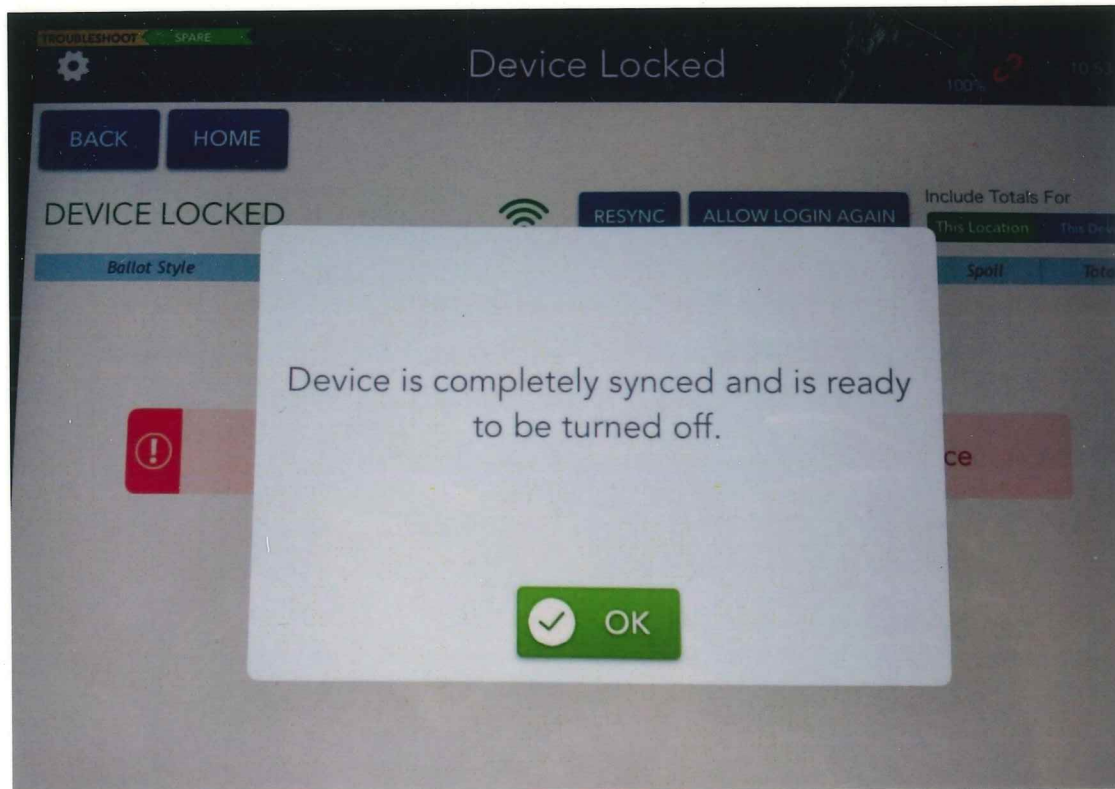

7. Unplug (VOTING MACHINE

8. If message does not appear, click 'resync' and wait.

9. If after completing the following steps above, if you are still unable to close, please call

973-881-4996